

INSTALLATION INSTRUCTIONS

Single-Handle (Cold Only) Lavatory Wall-Mounted Faucet 單把手炭牆式面盆龍頭安裝說明(冷水專用)

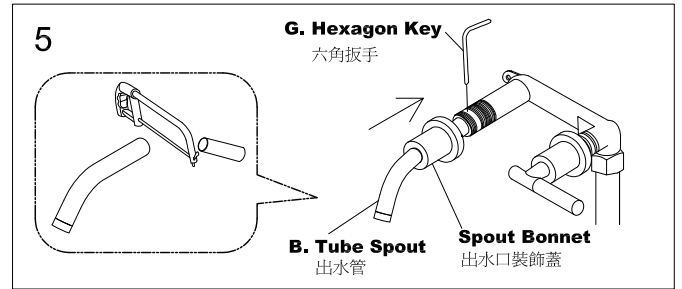
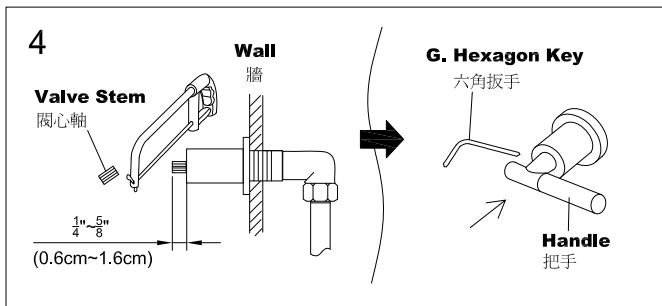
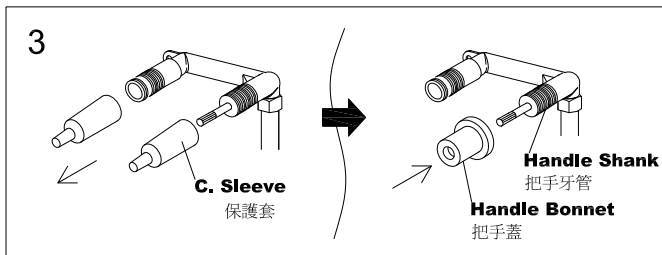
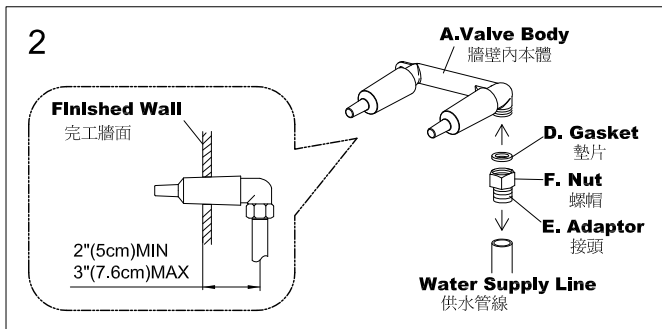
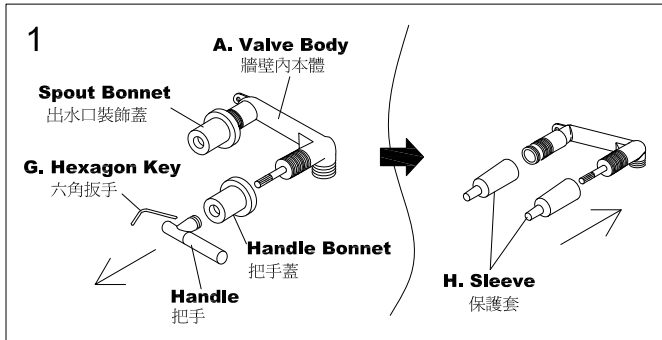

CAUTION : Risk Of Product Damage.

注意：為增加產品使用壽命，請依說明清潔供水管路。
Remove the aerator and fully turn on the faucet and run for 1 minute after finish installation, then turn off the water and reinstall the aerator.
完成安裝之後，把起泡器移開，把水全部轉開持續一分鐘，然後把水關掉再把起泡器裝回去。

NOTE: Unscrew the **Handle** and **Handle Bonnet** and **Spout Bonnet** from the Valve Body First. Using the **Sleeves** provided to protect the external threads while installation if required. (Fig.1)

注意從包裝盒中取出：安裝前，先將把手、把手蓋與把手裝飾蓋從本體鬆開。如須使用隨附塑膠保護套保護陶瓷中心柱及螺牙，必須在安裝程序前先套好。

1. Pay attention to minimum 2" (5cm) and maximum 3" (7.6cm) dimensions for mounting information as shown. (Fig.2)
牆壁內本體與牆面的距離須保持在最小2"(5cm)到最大3"(7.6cm)之間，此為安裝時的必要條件。
2. Install **Valve Body** and water supply Line. (Fig.2)
安裝牆壁內本體和供水管線。
3. Carefully take off **Sleeve** from **Valve Body**. Attach **Handle Bonnet** onto **Handle Shank** and cut overlong **Valve Stem** to certain length (1/4" ~ 5/8" or 0.6cm ~ 1.6cm) as shown, to fix the **handle**. (Fig.3 & Fig.4)
組裝前，小心取下塑膠保護套。裝置鎖緊把手蓋到牆內本體的牙管上，並依需要可切除凸出把手蓋過長的閥心軸。
4. Press Handles over the **Valve Stem** to proper position and tighten setscrew. When installing with **Lever Handle**, ensure that **Handle** are properly aligned when valves are in closed. (Fig.4)
將把手押入閥心軸到適當位置，並鎖緊側面的埋頭螺絲固定把手，當裝置一字把手時，須注意使把手在關閉時呈水平一字狀。
5. Cut **Tube Spout** to appropriate length if necessary, remove sharp edge on cutting area before installation. Slide **Spout Bonnet** onto **Tube Spout**, press **Tube Spout** into **Spout Shank** snug and tighten setscrew to fix **Tube spout** in position. (Fig.5)
出水口可依需要切短其長度，務必在切斷(短)後，去除管端割手的毛邊，再行組裝。將出水口裝飾蓋先套入出水口後，再將出水口插入牆壁內本體中間的牙管內孔中，並鎖緊牙管側面埋頭螺絲以固定出水口方向及長度。
6. Screw **Spout Bonnet** onto **Spout Shank**. (Fig.5)
鎖上出水口裝飾蓋，完成安裝程序。

FIXING CONTENTS

組配件內容

